

## SM35 Headworn Microphone

The Shure SM35 is a headworn electret condenser microphone, intended for use with a wireless bodypack transmitter in live stage performances.

### Wearing the Microphone

1. Install the windscreen on the microphone boom.
2. Place the headband around the back of the head, with the boom on the left side.
3. Place the microphone at the corner of the mouth. To decrease pops and plosives, avoid placing the microphone directly in front of the mouth

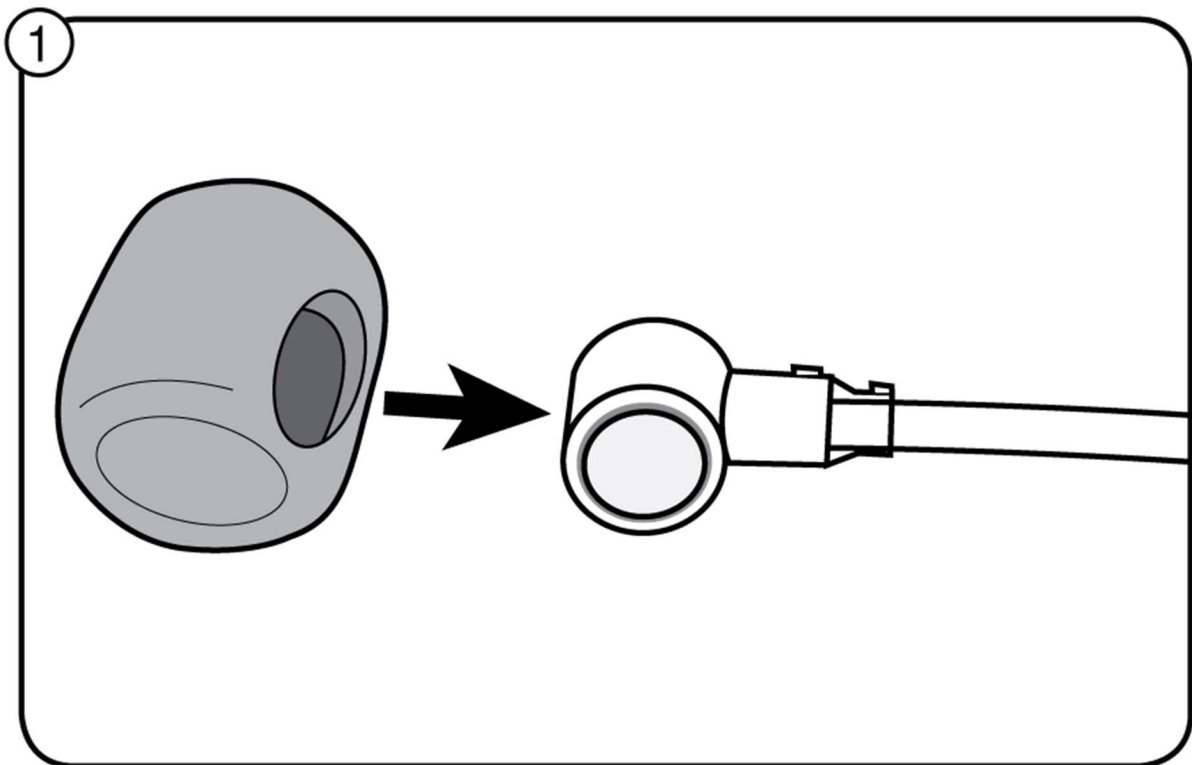

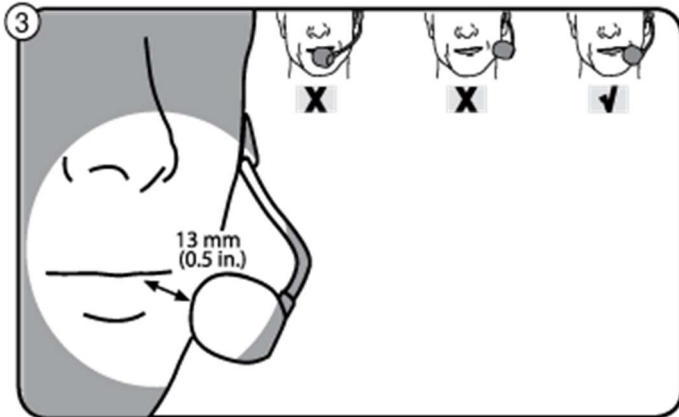
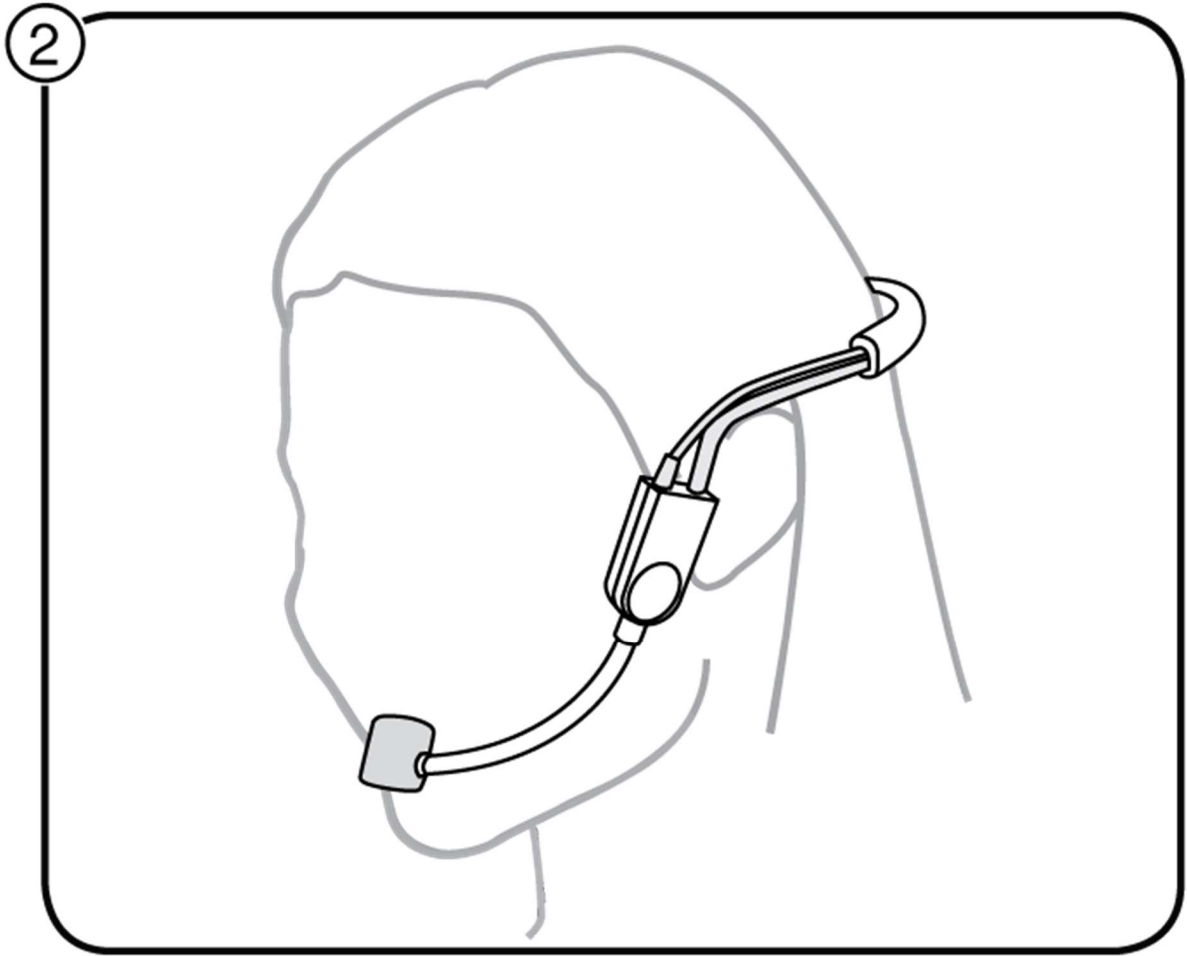

**Note:** Do not store the microphone in damp, enclosed spaces. Allow perspiration to dry completely before storing.

## Specifications

### Type

Electret Condenser

## **Frequency Response**

40 Hz to 20,000 Hz

## **Polar Pattern**

Unidirectional (Cardioid)

## **Output Impedance**

*@ 1 kHz*

2400  $\Omega$

## **Audio Output Level**

-59.0 dBV/Pa

## **Signal-To-Noise Ratio [1]**

*@ 1 kHz*

55 dB

## **Maximum SPL [1]**

*1000  $\Omega$  load, 1 kHz @ 1% THD*

153.0 dB

## **Dynamic Range [1]**

*@ 1 kHz, 1000  $\Omega$  load*

114.0 dB

## **Equivalent Output Noise [1]**

*typical, A-Weighted*

39 dB

## **Power Requirements**

Connector Type	
TA4F	XLR connector
+5 V DC (nominal), 10 V maximum (DC bias)	12 to 52 V DC, phantom power

## Polarity

Positive pressure on diaphragm produces positive voltage on pin 3 with respect to pin 1

## Cable

1.1 m (45 in.)

## Connector

TA4F or XLR

## Net Weight

72 g (2.53 oz.)

[1] Measurements taken using RPM626 preamp

\*All specifications measured with a 48 Vdc phantom power supply. The microphone operates at lower voltages, but with slightly decreased headroom and sensitivity.

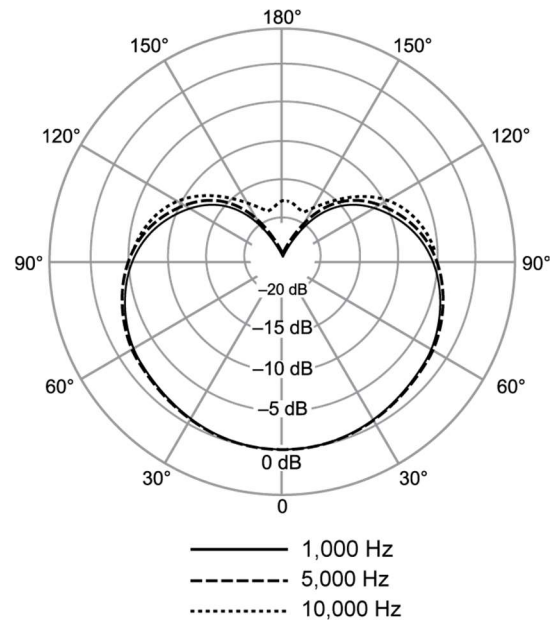
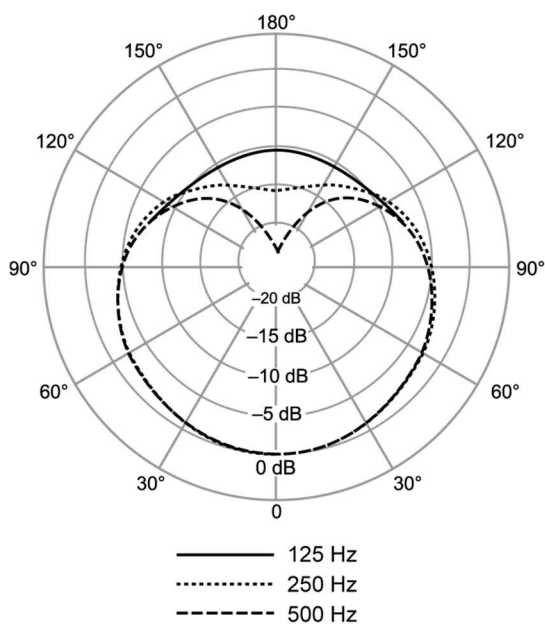

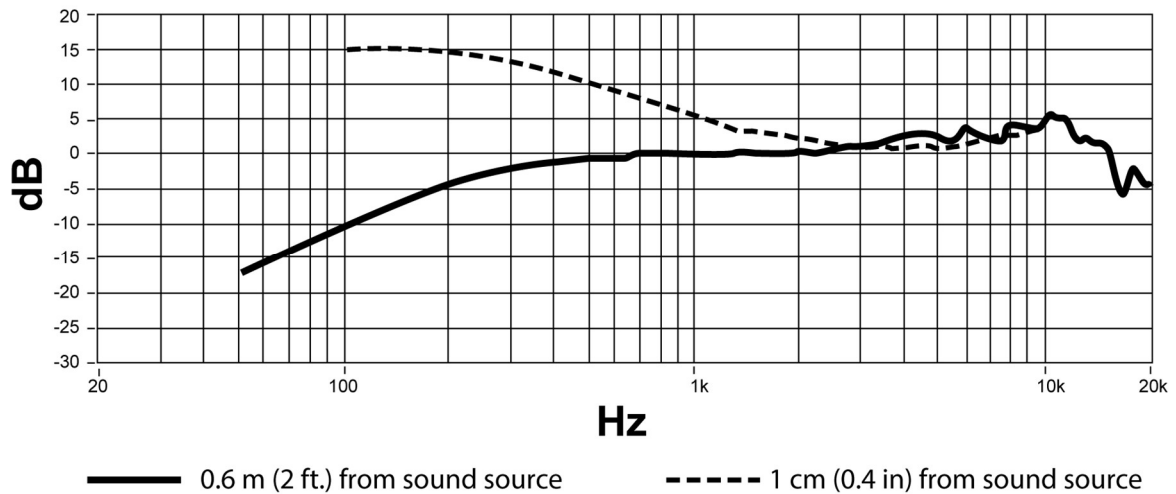

## Certifications

**Note:** Testing is based on the use of supplied and recommended cable types. The use of other than shielded (screened) cable types may degrade EMC performance.

The CE Declaration of Conformity can be obtained from: [www.shure.com/europe/compliance](http://www.shure.com/europe/compliance)

Authorized European representative:

Shure Europe GmbH

Headquarters Europe, Middle East & Africa

Department: EMEA Approval

Jakob-Dieffenbacher-Str. 12

75031 Eppingen, Germany

Phone: 49-7262-92 49 0

Fax: 49-7262-92 49 11 4

Email: [info@shure.de](mailto:info@shure.de)